

TRIO V2

SILENT & ENERGY SAVING

Low noise and low power two-speed exhaust axial fan with air flow up to 300 m³/h



Air flow:
up to 300 m³/h
83 l/s



Power:
from 5 W
SFP:
from 0.25 W/l/s



Noise level:
from 23 dBA



Features



- 2 speed modes: I – for the permanent ventilation, II (by a sensor or switch) – for the intermittent ventilation.
- Wall and ceiling mounting.
- The casing, impeller and the front panel are made of high-quality and UV-resistant ABS plastic.
- The aerodynamic design of the impeller ensures high air flow and low noise level.
- The fan outlet pipe incorporates specially designed air rectifiers to reduce air turbulence, noise level and increase air pressure.
- The fan is equipped with a specially designed backdraft damper to prevent back flow and heat losses during the fan standby.
- Ventilation shaft mounting or connection to Ø 100 mm and Ø 150 mm air ducts.
- Maintenance-free bearings contain enough grease for 40 000 hrs of non-stop operation.

Options



Model	Trio V2 100 / Trio V2 150	
Option	TR	H
Turn-on delay timer	•	•
Turn-off delay timer	•	•
Humidity sensor		•

TR OPTION

- **Turn-on delay timer**
 - Adjustable delay from 10 seconds to 2 minutes.
- **Turn-off delay timer**
 - Adjustable delay from 2 to 30 minutes.

H OPTION

- **Turn-on delay timer**
 - A non-adjustable turn-on delay timer of 45 s, when the switch is closed; turn-on delay is not available when the humidity sensor is activated.
- **Turn-off delay timer**
 - An adjustable turn-off delay from 2 to 30 min after the switch is opened. If the humidity sensor is activated, the turn-off delay time is fixed (5 min).
- **Humidity sensor**
 - Humidity sensor activation threshold is adjustable from 60 % to 90 %.

Overall dimensions and mounting

- The fan is installed directly into the ventilation shaft.
- Flexible duct connection is recommended in case of the remote ventilation shaft location. The air duct is connected to the fan exhaust spigot through a clamp.
- Fixation to the wall or ceiling with screws.

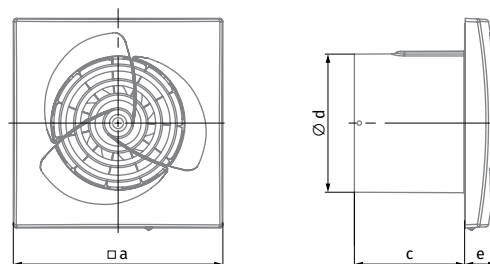

Dimensions [mm]	a	c	Ø d	e
Trio V2 100	150	79	99	23
Trio V2 150	206	100	148	23

Designation key			
Trio	V2	100	H
Model	Two-speed motor	Spigot diameter	Option

Accessories

Duct system



BlauPlast

Flexible air ducts



BlauFlex

Grilles and hoods



Decor, GM

Clamps



K, KZ

TRIO V2

SILENT & ENERGY SAVING

Technical data

Model	Trio V2 100		Trio V2 150	
	min	max	min	max
Speed				
Voltage [V/Hz]	220-240/50		220-240/50	
Power [W]	5	8	18	21
Current [A]	0.03	0.05	0.079	0.085
Air flow [m³/h (l/s)]	54 (15)	81 (23)	210 (58)	300 (83)
SFP [W/l/s]	0.33	0.36	0.31	0.25
Sound pressure level [dBA]*	23	28	29	35
Weight [kg]	0.55		0.97	

* Sound pressure level measured in free space at a distance of 3 meters from the fan.

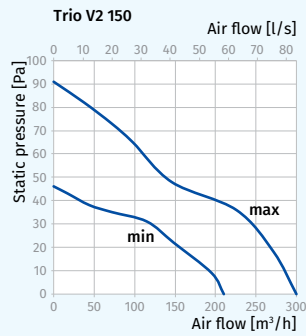
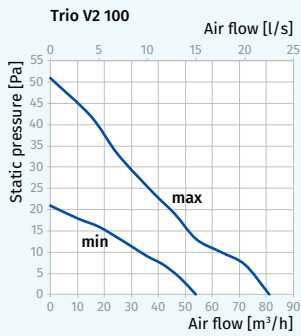

CE GS IP44

Application example

