

## FITTINGS

### FITTINGS FOR ROUND AIR DUCTS

#### o Flange for round ducts FRM, FRZ

- Made of white polymer coated steel (**FRM**) or galvanized steel (**FRZ**)
- The **FRZ ... S** models are equipped with a U-shape sealant to avoid air leakage
- Connection of round flexible air ducts
- Wall or ceiling mounting with screws

Model	Ø D [mm]	Ø D1 [mm]	L [mm]
FRM 80	80	116	62
FRM 100	100	136	62
FRM 125	125	162	62
FRM 150	150	186	62
FRM 160	160	196	62
FRM 200	200	236	62
FRM 250	250	286	62
FRM 315	315	351	62
FRZ 80	80	116	62
FRZ 100	100	136	62
FRZ 125	125	162	62
FRZ 150	150	186	62
FRZ 160	160	196	62
FRZ 200	200	236	62
FRZ 250	250	286	62
FRZ 315	315	351	62
FRZ 100 S	100	136	62
FRZ 125 S	125	162	62
FRZ 150 S	150	186	62
FRZ 200 S	200	236	62

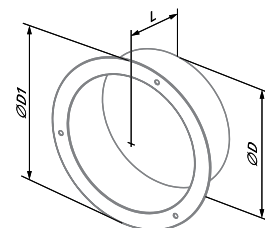

#### o Round duct reducer RSM, RSZ

- Made of white polymer coated steel (**RSM**) or galvanized steel (**RSZ**)
- For connection of round air ducts

Model	Ø D [mm]	Ø D1 [mm]	L [mm]
RSM 80/100	80	100	115
RSM 100/125	100	125	125
RSM 100/150	100	150	125
RSM 125/150	125	150	125
RSM 125/160	125	160	144
RSM 150/160	150	160	172
RSM 160/200	160	200	154
RSM 150/200	150	200	172
RSM 200/250	200	250	172
RSM 250/315	250	315	195
RSZ 80/100	80	100	115
RSZ 100/125	100	125	125
RSZ 100/150	100	150	125
RSZ 125/150	125	150	125
RSZ 125/160	125	160	144
RSZ 150/160	150	160	172
RSZ 160/200	160	200	154
RSZ 150/200	150	200	172
RSZ 200/250	200	250	172
RSZ 250/315	250	315	195

